

DNV Assembly Instructions

Installation Tools

The following tools are required to assemble / fit the mounting brackets.

This is not an exhaustive list of tools required to install the drive.

The tools are not supplied with the DNV kit.

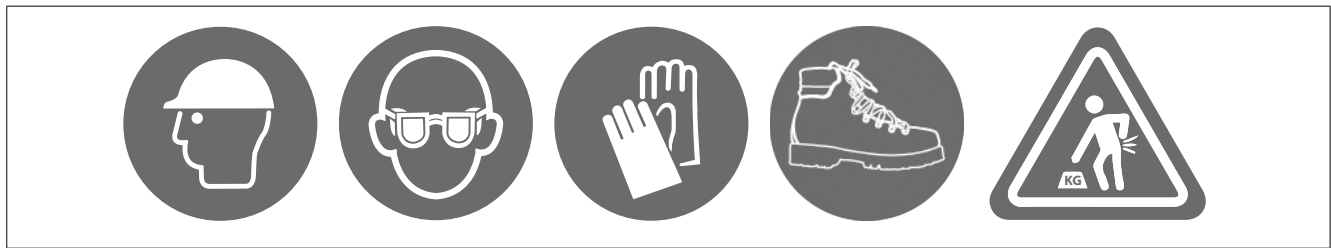
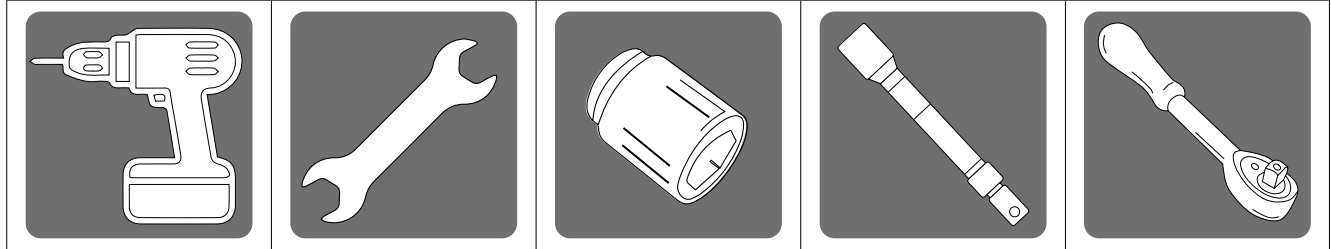

Contents of kit

Item	Image	Description	Quantity	Item	Image	Description	Quantity
A			2	F		M10 Steel Washer	4
B		M10 35mm HEX	4	G		M10 Nut	4
C		M10 Spring Washer	4	H		Anti-vibration mount	4
D		M10 50mm Stainless steel Washers	4	I		Flat Washer M12	4
E		M10 30mm Nylon Spacer Washer (Black)	4	J		M12 40mm HEX Bolt	4

Assembly of mounting brackets

Tools required:

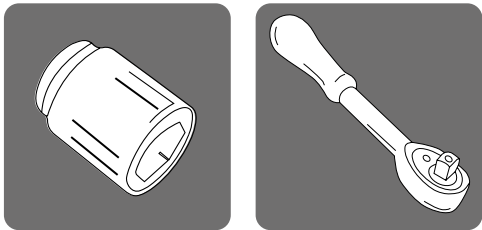

Top of drive:

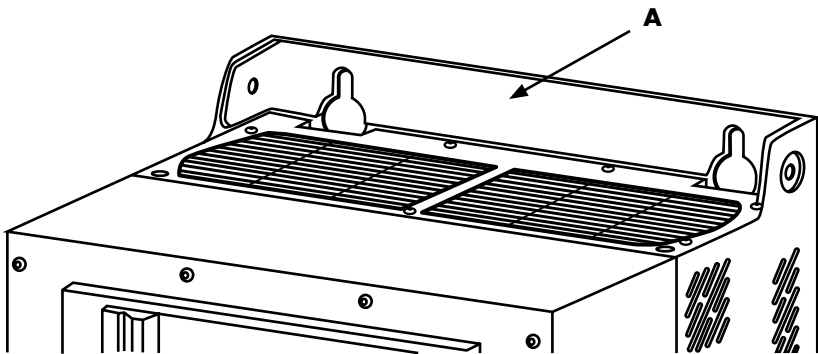

Bottom of drive:

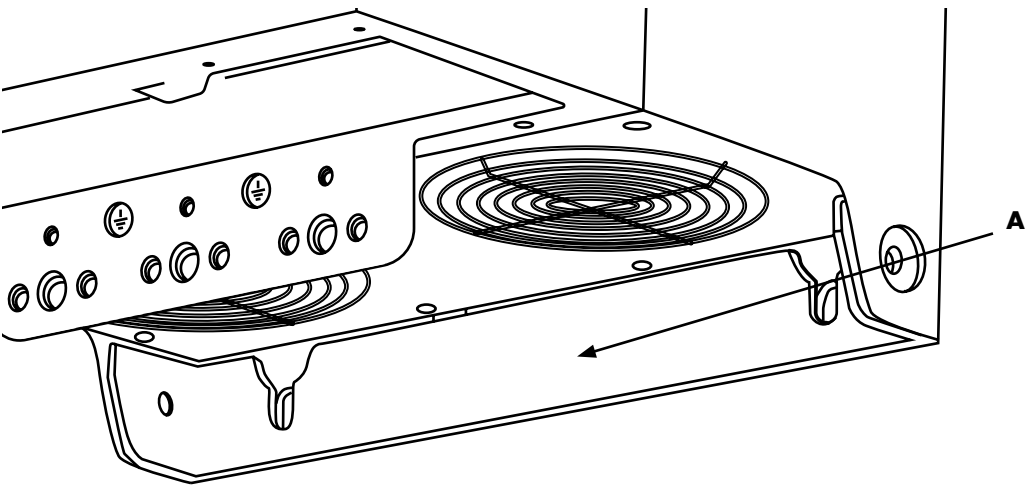

Top of drive:

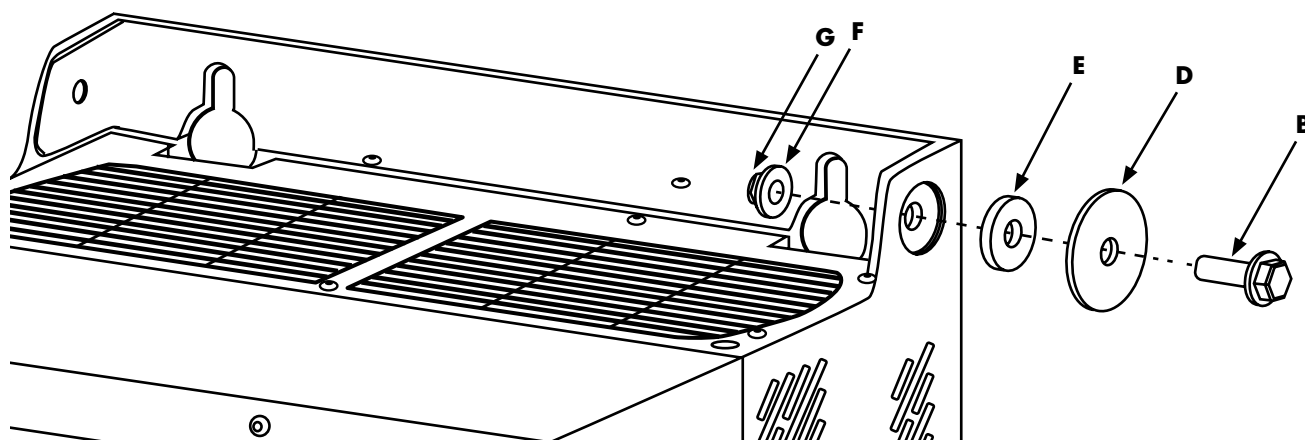
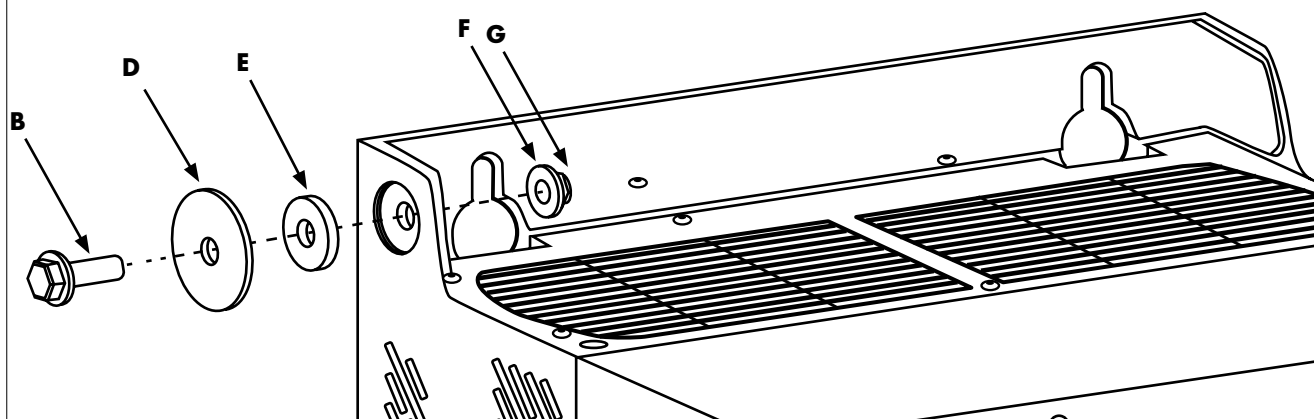

Bottom of drive:

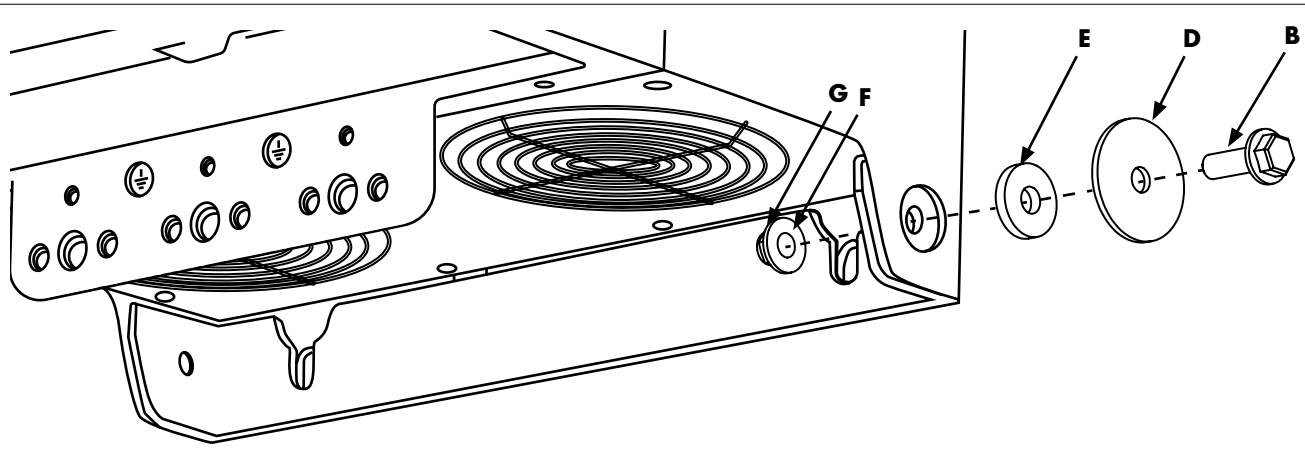
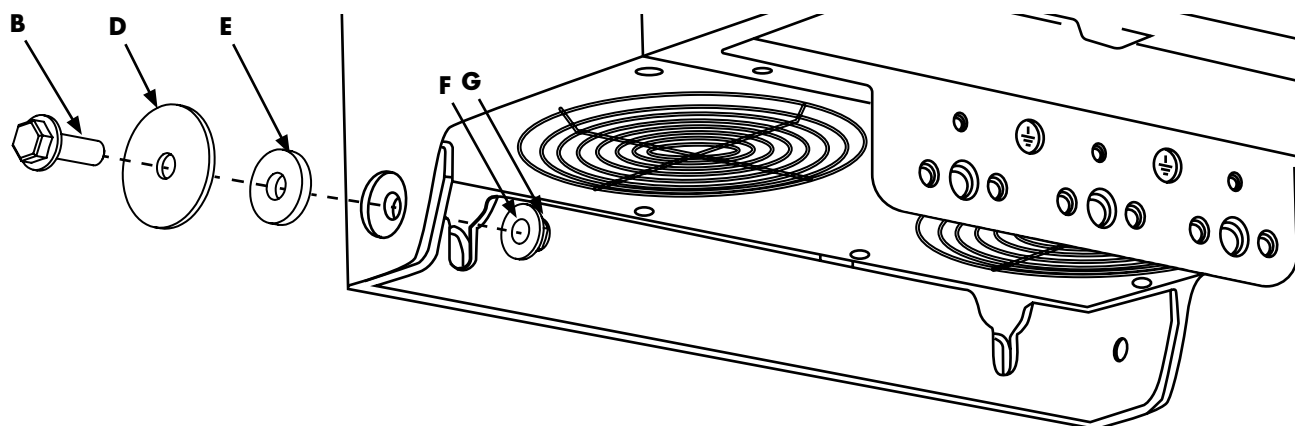

Fixing the drive to anti-vibration mounts

Tools required:

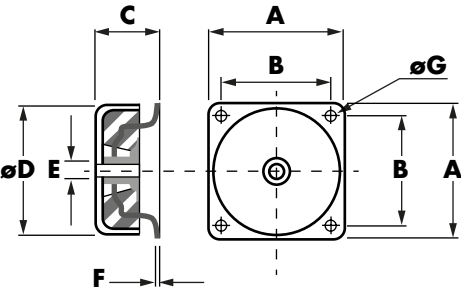
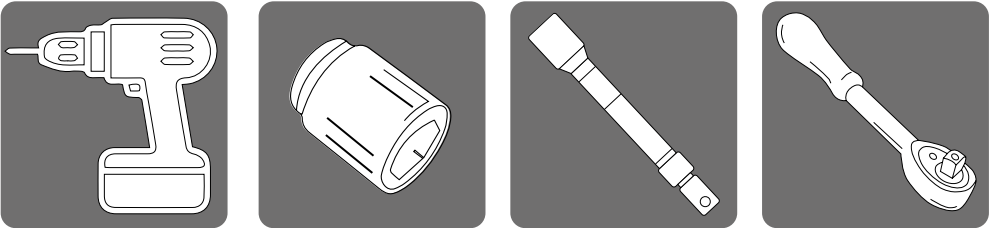

A	B	C	Ø D	E	F	Ø G
mm	mm	mm	mm	mm	mm	mm
90.0	74.0	38.0	76.0	M12×1.75	2.5	9.0

NOTE Screws for the anti-vibration mounts to the wall are not provided, they should be suitable for the weight and surface that the drive will be mounted to. See Drive user guide for weights and dimensions.

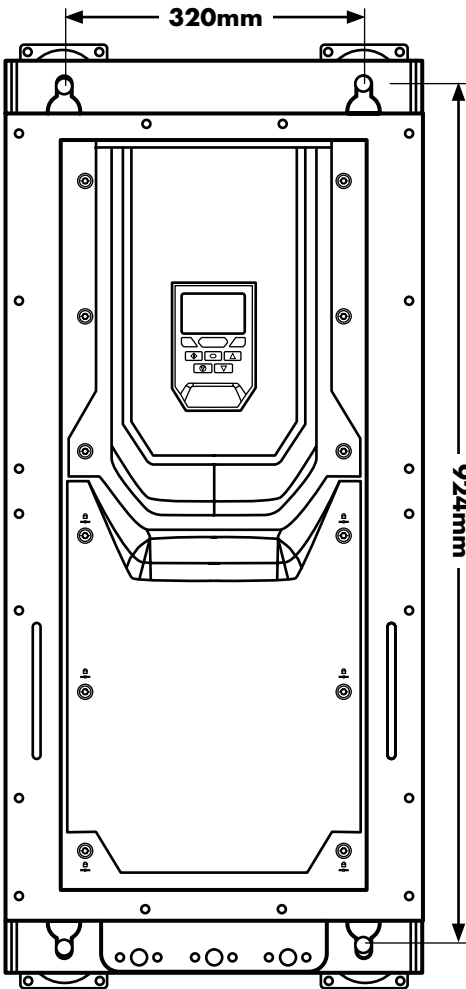

Upper side:

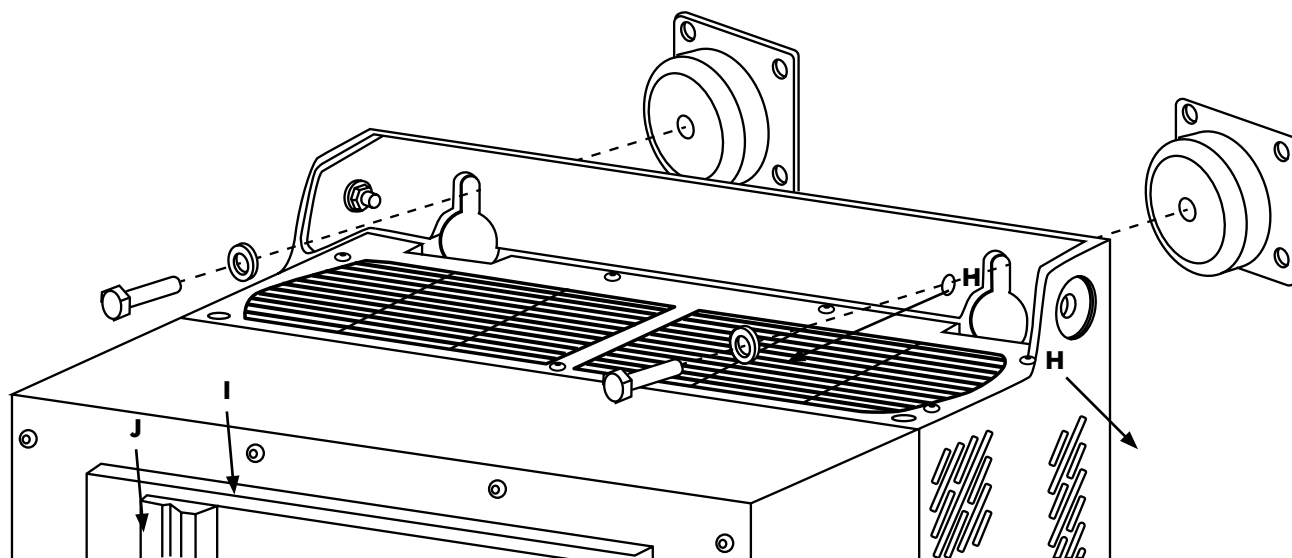

Lower side:

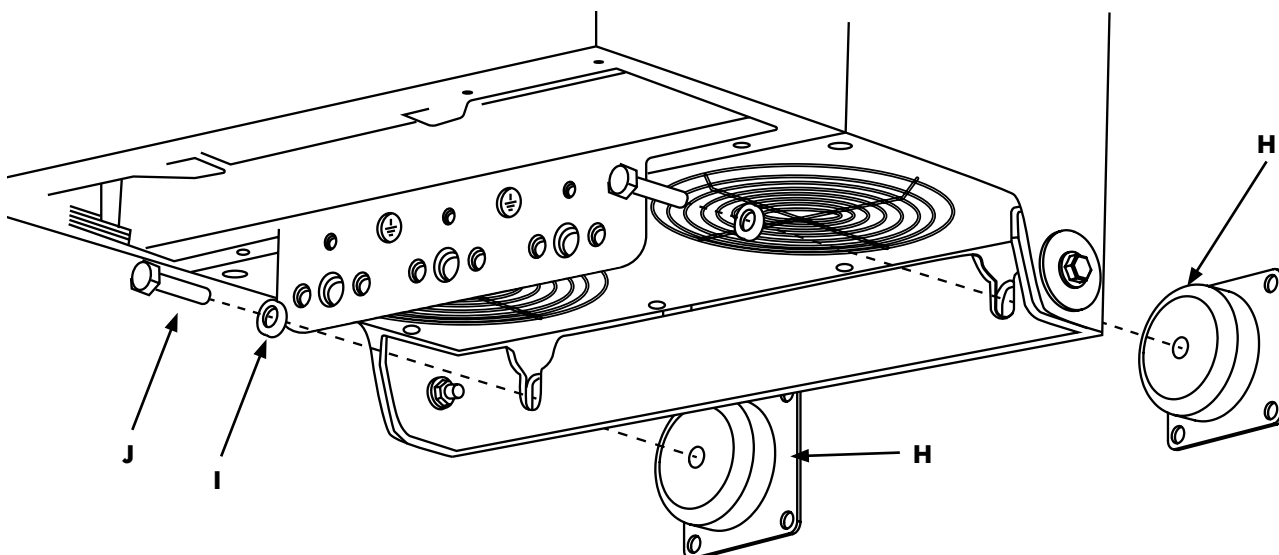



82-S8DNV-00_V1.00